

GASTON COUNTY SEPTIC TANK INSPECTION RECORD
ENVIRONMENTAL HEALTH DIVISION

CODE/SUB Woodland Bay

DATE 9-21-12

Owner Name: Joseph + Suzanne Cunningham

of Tanks: 1 Cap: 1000

Address: 5157 Woodland Bay

of Tanks: _____ Cap: _____

City/St.: Belmont NC 28012

System Class: IIA

Zip: _____

Description: _____

Prev. Owner: _____

25pked Biodivisor Chambers.

Receipt #: 3279

Sub. Name: Woodland Bay

Date Installed: 9-21-12

Location: _____

IP/CA #: 25563

5157 Woodland Bay

Type Dwelling: House

of Bedrooms: 4

of Users/Total People: 8 max

Well Type: D Lot# 52 Block _____

Garbage Disposal: No Y/N

Lot Area: 1.02

Basement: No Plumbing: _____ Y/N

Installer: R+H

Est. Daily Flow: 480 gpd

Precast Manufacturer: Stronpe

of Trenches: 5 Sq. Ft.: 1200

Lin. Ft.: 400 Width: 36" Max. Depth: 36"

(Repair) # Trenches: _____ Sq. Ft.: _____

Lin. Ft.: _____ Width: _____ Max. Depth: _____

Sep. Trench/Wash: _____ Sq. Ft.: _____

Lin. Ft.: _____ Width: _____ Max. Depth: _____

Depth of Aggregate: _____

Type of Aggregate: Biodivisor Arc 36

PID: 1988 70

PIN: 358282/8026

(A) Public Community (B) Public Non-Community (C) Private (D) Community (E) Municipal N

IP/CA Issued By: Ronald C. Shannon RCHS

Inspected By: Ronald C. Shannon RCHS

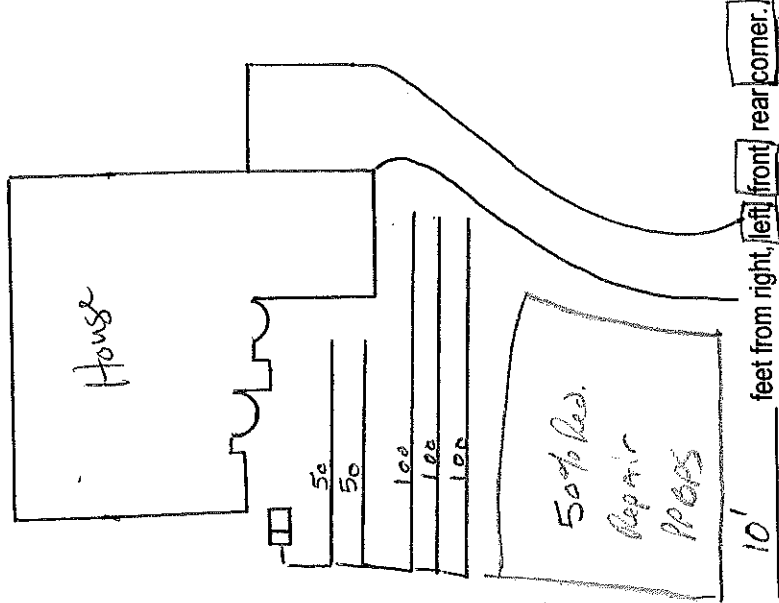

HOUSE SEWER: 10' feet from right, left, front, rear corner.

SEPTIC TANK: Front, rear right side, left, side of building. Perpendicular, parallel, angle 10' feet from building.

DISTRIBUTION DEVICE: 12' feet from end, side, corner of septic tank.

DRAIN FIELD: 20' feet from building at nearest point.

WELL (IF ANY): 100 feet from septic tank and 100 feet from disposal field.

SITE CLASSIFICATION: Suitable, Provisionally Suitable.

REMARKS: _____

