

Building Sketch

Borrower	Roger Milam						
Property Address	2690 Cypress Oak Ln						
City	Gastonia	County	Gaston	State	NC	Zip Code	28056
Lender/Client	PrimeLending						

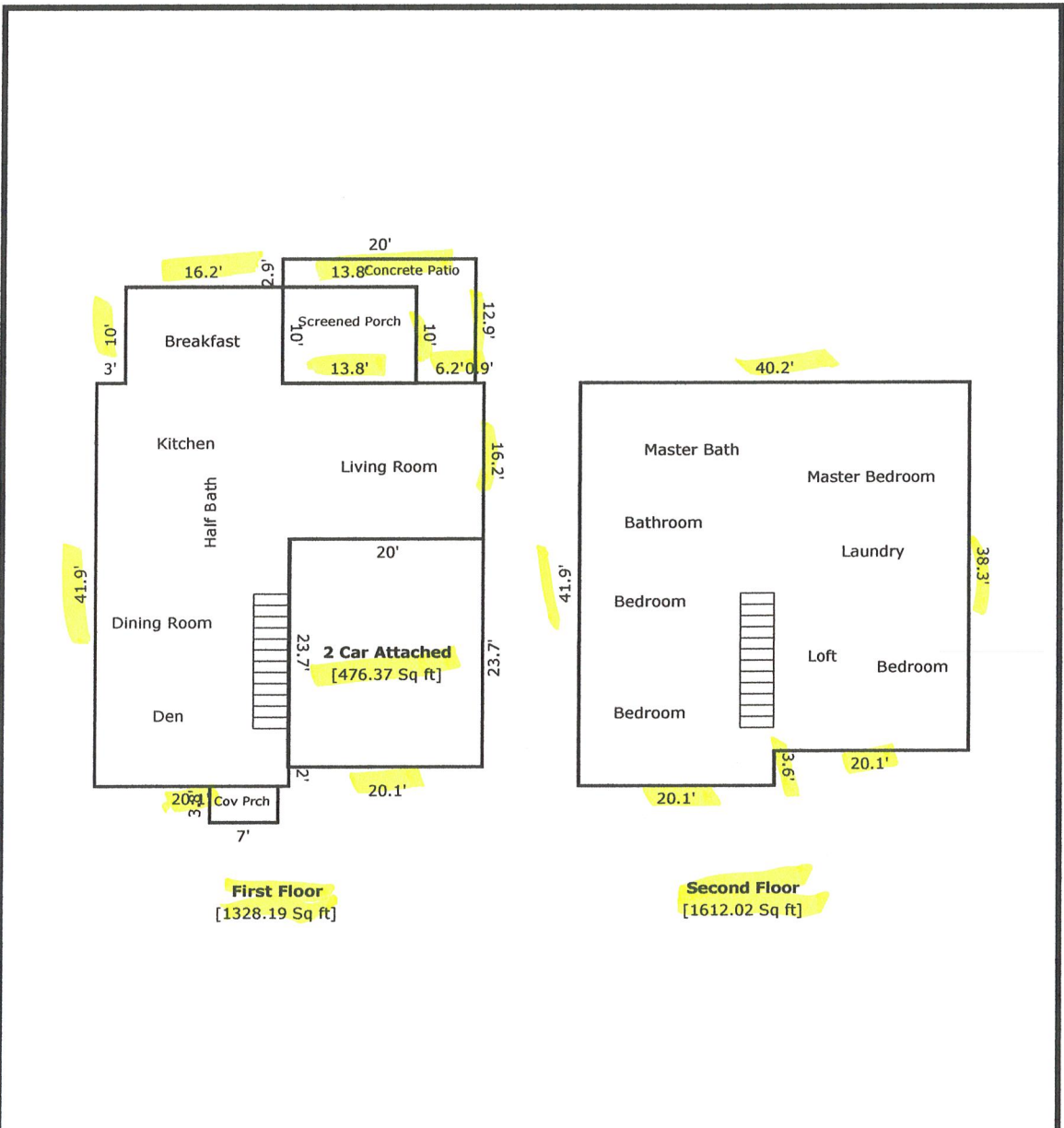

First Floor
[1328.19 Sq ft]

Second Floor
[1612.02 Sq ft]

TOTAL Sketch by a la mode, inc.		Area Calculations Summary	
Living Area			Calculation Details
First Floor	1328.2 Sq ft		16.2 × 10 = 162 16.2 × 20 = 324 41.9 × 20.1 = 842.2
Second Floor	1612 Sq ft		40.2 × 38.3 = 1539.7 3.6 × 20.1 = 72.4
Total Living Area (Rounded):	2940 Sq ft		
Non-living Area			
2 Car Attached	476.4 Sq ft		23.7 × 20.1 = 476.4
Concrete Patio	120 Sq ft		6.2 × 10 = 62 20 × 2.9 = 58
Screened Porch	138 Sq ft		10 × 13.8 = 138