

York County GIS Property Report

Acc #: 253242
622 PLOWSHARE WAY

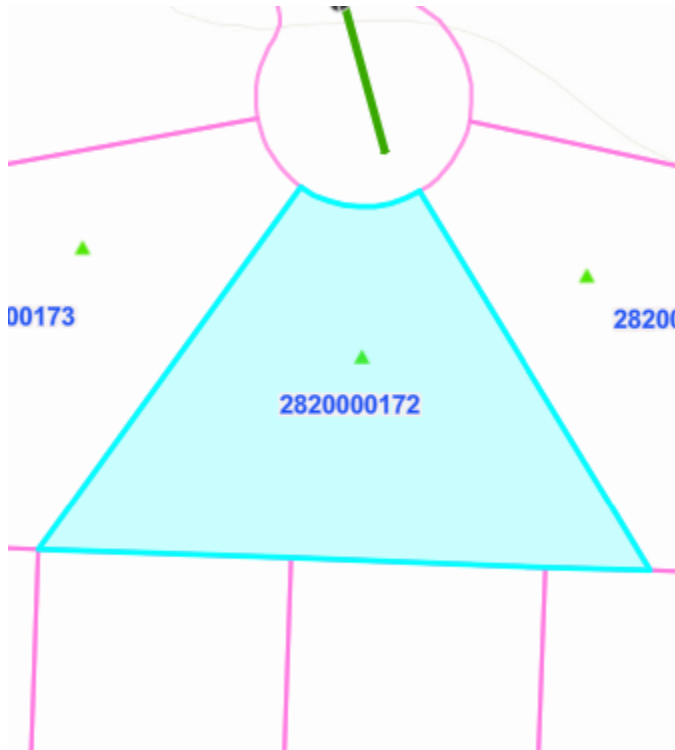

Property Data

Parcel Number: 2820000172
PIN: 2820000172
Lot: 34
Deeded Acres: 1.01
GIS Acres: 1.01
Deed Book / Page: 2159 / 325
3
Sold Date: 11/1/2024
Sold Price: 678000
Grantor:
Plat Book / Page: 170 / 433

Legal Description

LOT# 34 EDMUNDS FARM

Subdivision

EDMUNDS FARM SDV phase 1

Primary Contact (Owner)

Name Line 1 CANFIELD MICHAEL SCOTT
Name Line 2 CANFIELD DEBORAH
Name Line 3

Tax Districts

School District: 2
Municipal District:
Fire District: CL-I

Mailing Address

Addr Line 1 622 PLOWSHARE WAY
Addr Line 2
Apt
City CLOVER
State SC
Zip 29710
Country US

Values

Market Land Value	\$95000
Market Imp Value	\$557300
Market Misc Value	\$0
Total Market Value	\$652300
Total Taxable Value	\$652300
Total Assessed Value	\$26092

Disclaimer: While every effort is made to keep information provided over the internet accurate and up-to-date, York County does not certify the authenticity or accuracy of such information. No warranties, express or implied, are provided for the records and/or mapping data herein, or for their use or interpretation by the User.

Report Generated: 5/1/2026 10:26 AM